

## Main Feature

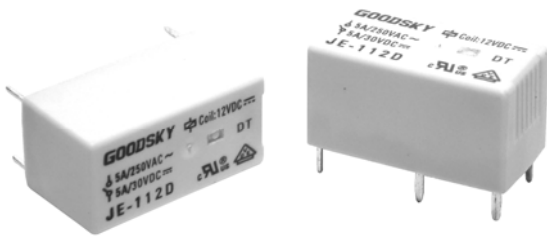

1. 1 N/O & 1 C/O Contact
2. Sensitive coil 200mW.
3. Dielectric strength between coil & contact 4KV.
4. Low profile 10.5 mm.
5. Class I protection conforms to Industrial Norm, clearance and creepage more than 5.0 mm.
6. Cadmium-Free Contacts.

## Contact Rating



Load Type	JE (DM)	JE (D)
Rated Load (Resistive)	8A 250VAC	5A 250VAC
	8A 30VDC	5A 30VDC
Max. Allowable Voltage	AC 440V	AC 380V
	DC 30V	DC 30V
Max. Allowable Current	8A	5A
Max. Allowable Power Force	1,500VA	1,250VA
	240W	150W
Contact Material	Ag Alloy	Ag Alloy
Contact Form	SPST	SPDT

## Application

1. Industrial Electronic Instrument, PLC, Timers, Temperature Control & Measure.
2. White goods.
3. Building Automation.
4. Air Conditioner.
5. Actuating Driver.

## Performance (at Initial Value)

- Contact Resistance ..... 100 mΩ Max. @1A,6VDC
- Operate Time..... 8 mSec. Max.
- Release Time ..... 4 mSec. Max.
- Dielectric Strength:
  - Between Coil & Contact ..... 4,000VAC at 50/60 Hz for one minute.
  - Between Contacts ..... 1,000VAC at 50/60 Hz for one minute.
- Surge Strength ..... 10,000V (between coil & contact 1.2x50μSec.)
- Insulation Resistance ..... 100 MegaΩ Min. at 500VDC.
- Max. On/Off Switching:
  - Electrical..... 15 Cycles per Minute.
  - Mechanical ..... 300 Cycles per Minute.
- Temperature Range..... -40~85°C

- Humidity Range..... 45~85% RH.
- Coil Temperature Rise..... 40°C Max.
- Vibration:
  - Endurance ..... 10 to 55 Hz dual amplitude width 1.5mm.
  - Error Operation..... 10 to 55 Hz dual amplitude width 1.5mm.
- Shock:
  - Endurance ..... 1,000m/S<sup>2</sup>.
  - Error Operation..... 100 m/S<sup>2</sup>.
- Life Expectancy:
  - Mechanical ..... 10<sup>7</sup> Operations at No load condition.
  - Electrical ..... 10<sup>5</sup> Operations at Rated Resistive Load.
- Weight ..... about 6.0 g.

## Safety Standard & Its File Number

- C-UL ..... E141060
- VDE ..... 40013405

**Coil Specification (at 20 °C)**

Coil Sensitivity	Nominal Voltage (VDC)	Nominal Current (mA)	Coil Resistance ( $\Omega \pm 10\%$ )	Power Consumption (W)	Pull-In Voltage (VDC)	Drop-Out Voltage (VDC)	Maximum Allowable Voltage (VDC)
JE	3	66.7	45	Abt. 0.2	75% Maximum	5% Minimum	150%
	5	40.0	125				
	6	33.3	180				
	9	22.2	405				
	12	16.7	720				
	24	8.3	2,880				
	48	4.2	11,520				

**Ordering Information**

JE - 1 12 D M - G

**Contact Material:**

**Nil:** AgNi

**G:** AgNi Gilded

**O:** AgNi Plated

**N:** AgSnO<sub>2</sub>

**S:** AgSnO<sub>2</sub> Gilded

**Contact Form:**

**Nil:** One Form C

**M:** One Form A

**Coil Type:**

**D:** Standard DC Coil

**Coil Voltage:** 03: 3V, 05: 5V, 06: 6V, 09: 9V, 12: 12V, 24: 24V, 48: 48V

**Number of Pole:**

**1:** One Pole

**Type:**

**JE**

**Classification**

Model	JE	
Coil Sensitivity	Standard DC Coil	
Contact Form	1C	1A
Plastic Sealed Type	JE - 1□□D - □	JE - 1□□DM - □

**Dimension ( $\leq 5\text{mm} \pm 0.2\text{mm}$ ,  $> 5\text{mm} \pm 0.3\text{mm}$ , the tolerance of PCB thru hole:  $+0.1\text{mm}$ )**

JE-D

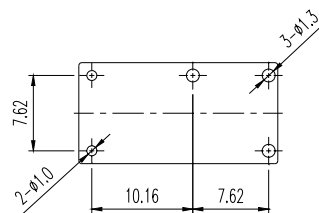
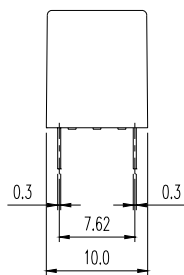
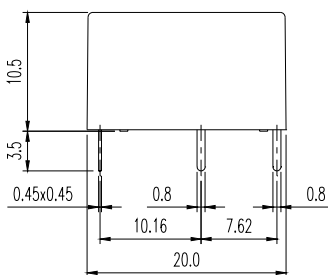

BOTTOM VIEW

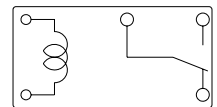

BOTTOM VIEW

JE-DM

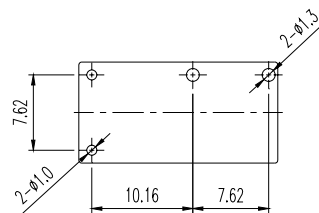
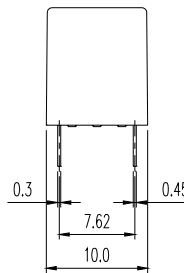
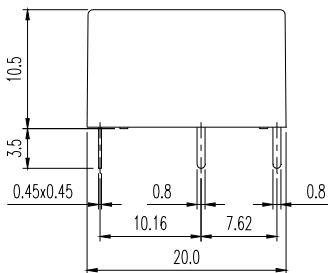

BOTTOM VIEW

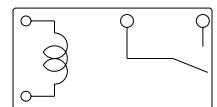

BOTTOM VIEW